

QDRHA-1000-20000-12.58

1~20GHz, 12.58dB

Features:
* Broadband

Applications:
* Wireless
* Transceiver
* Laboratory Test
* Broadcast

Electrical

Frequency:	1~20GHz
VSWR:	2 max.
Gain:	12.58dB
H Plane Beam Width:	11.29°~60.56°
E Plane Beam Width:	13.52°~78.41°

Mechanical

Size:	243*163.5*205.7mm 9.567*6.437*8.098in
-------	--

Outline Drawings

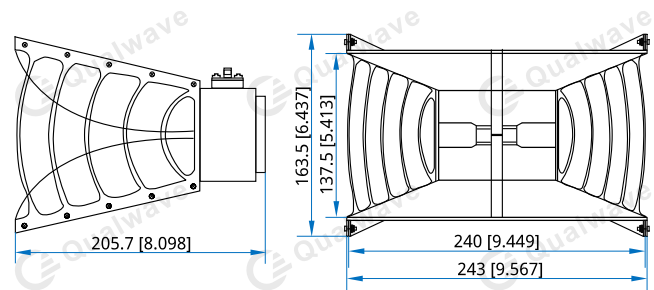

Unit: mm [in]

Tolerance: ± 0.2 mm [± 0.008 in]

How To Order

[QDRHA-1000-20000-12.58](#)

Customization is available upon request.