

QCS-MB-141-3

SMA Male

Features:
* Low VSWR

Applications:
* Wireless
* Radar
* Instruments
* Electronics

Electrical

Frequency: DC~18GHz
VSWR: 1.25 max.

Mechanical

RF Connector: SMA Male
Mating Cable: QH400, QE141, QD141
Outer Conductor: Gold Plated Brass
Dielectric: PTFE
Inner Conductor: Gold Plated Brass

How To Order

[QCS-MG-141-3](#)

Customization is available upon request.

Outline Drawings

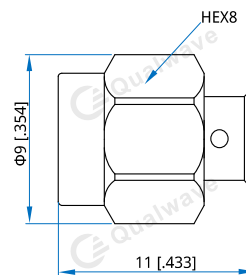

Unit: mm [in]
Tolerance: ± 0.2 mm [± 0.008 in]