

# QASF

## SMA to F Inch Thread

Features:  
\* Low VSWR

Applications:  
\* Wireless  
\* Transmitter  
\* Laboratory Test  
\* Radar

### Specifications

| Model   | Frequency (GHz) | VSWR (max.) | Voltage Withstand (V) | Impedance of Dielectric (mΩ min.) | Impedance (Ω) | Outer Conductor     | Dielectric | Inner Conductor              | Outline Drawings |
|---------|-----------------|-------------|-----------------------|-----------------------------------|---------------|---------------------|------------|------------------------------|------------------|
| QASF-FM | DC~2            | -           | 750                   | 1000                              | 75            | Nickel plated brass | PTFE       | Gold plated beryllium copper | Outline A        |
| QASF-FF | DC~2            | -           | 750                   | 1000                              | 75            | Nickel plated brass | PTFE       | Silver plated brass          | Outline B        |

### Mechanical

RF Connectors: SMA  
F Inch Thread  
Mating Life Cycle: 500 cycles

### How To Order

**QASF-FM** - SMA(f) to F Inch Thread (m), Outline A  
**QASF-FF** - SMA(f) to F Inch Thread (f), flange mount, Outline B

### Outline Drawings

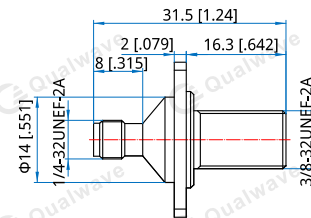
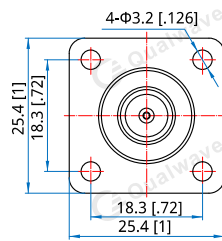
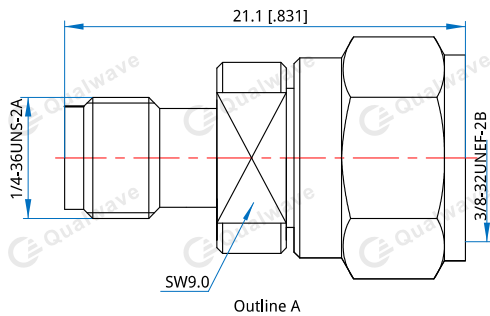

Unit: mm [in]

Tolerance: ±0.2mm [±0.008in]

Customization is available upon request.