

QASQS-B

SMA to Quick SMA

Features:
* Low VSWR

Applications:
* Wireless
* Transmitter
* Laboratory Test
* Radar

Electrical

Frequency:	DC~18GHz
VSWR:	1.25 max.
Insert Loss:	0.25dB max. (Outline A)
Impedance of Dielectric:	5000MΩ min.
Voltage Withstand:	1000V DC min.
Impedance:	50Ω

Mechanical

RF Connectors:	SMA Quick SMA
Mating Life Cycle:	1000 cycles min. (Outline A)
Outer Conductor:	Gold plated brass (Outline A) Nickel plated brass & Gold plated beryllium copper
Dielectric:	PTFE
Inner Conductor:	Gold plated brass & Gold plated beryllium copper (Outline A) Gold plated beryllium copper

How To Order

QASQS-FM-B - SMA (f) to Quick SMA (m), Outline A

QASQSL-FM-B - SMA (f) to Quick SMA (m), flange mount, Outline B

Customization is available upon request.

Environmental

Temperature: -55~+155°C (Outline A)

Outline Drawings

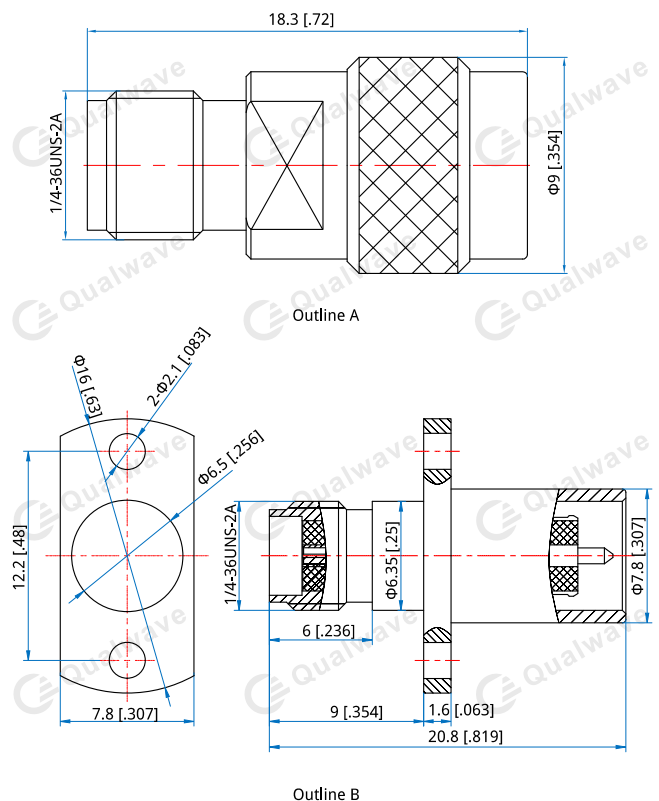

Unit: mm [in]

Tolerance: ±0.2mm [±0.008in]