

QVLC-1F-1

1mm, DC~110GHz

Features:

- * Low VSWR
- * No welding
- * Reusable
- * Easy installation

Applications:

- * Laboratory Test

Electrical

Frequency:	DC~110GHz
VSWR:	1.5 max.
Impedance:	50Ω

Mechanical

RF Conductor:	1.0mm Female
Inner Conductor:	Gold plated beryllium copper
Outer Conductor:	SUS303 stainless steel

How To Order
QVLC-1F-1

Customization is available upon request.

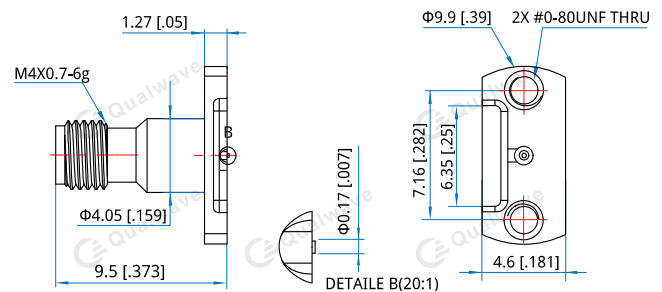
Outline Drawings

Unit: mm [in]

 Tolerance: $\pm 0.2\text{mm}$ [$\pm 0.008\text{in}$]